

## 19.2 GHz Surface Mount Band pass Filter

### B192NB2S

#### DESCRIPTION

One of DLI's surface mountable catalog band pass filters. This filter utilizes DLI's low loss temperature stable materials which offer small size and minimal performance variation over temperature. The catalog BPF's are offered in a variety of frequency bands, which offers a drop in solution with highly repeatable performance.

#### FEATURES

- Small Size
- Fully Shielded Component
- Solder Surface Mount Package
- Moisture Sensitivity Level: MSL1
- Frequency Stable over Temperature
- Operating & Storage Temp: -55°C to +125°C
- Characteristic Impedance: 50Ω

#### SPECIFICATIONS\*

Parameter	Frequency Range (GHz)	Min	Typ.	Max
Insertion Loss (dB)	17.2 - 21.2	-	4.0	4.25
Return Loss (dB)		10	12	15
Low Side Rejection (dB)	DC – 16.0	40	50	45
High Side Rejection (dB)	22.8 - 35.0	45	50	55
Input Power (W)			TBD	
Size (L x W x H)	0.450 x 0.140 x 0.083 in 11.43 x 3.55 x 2.1 mm			

\*Electrical specifications based on typical probed performance at room temperature. Insertion loss shall vary  $\pm 0.5$ dB over temperature.

#### Typical Measured Performance

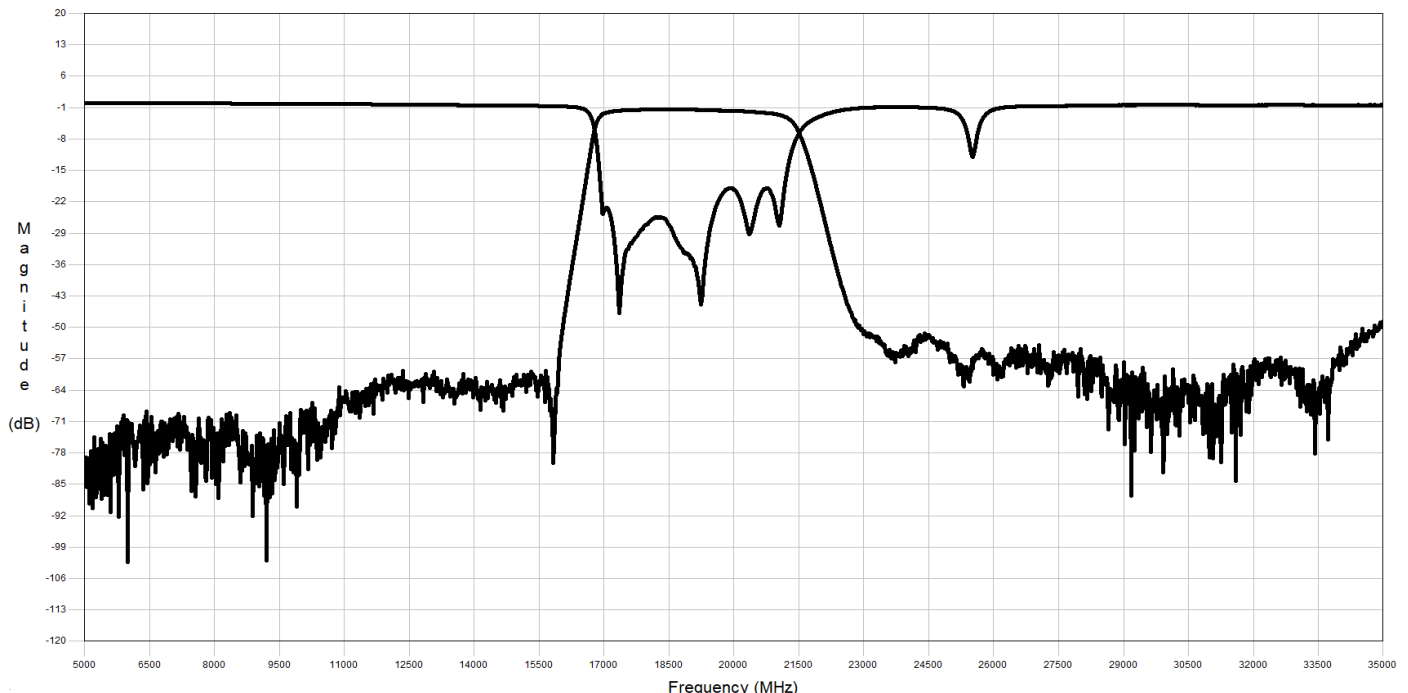

**19.2 GHz Surface Mount Band pass Filter**

**B192NB2S**

**Physical Dimensions**

Units = inches

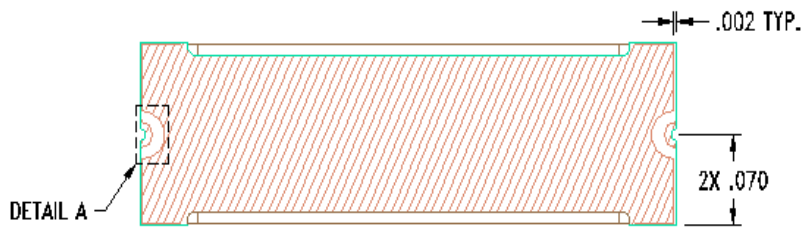
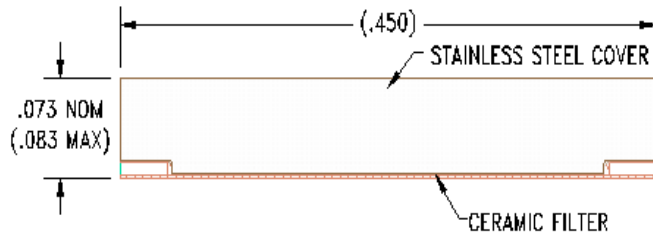
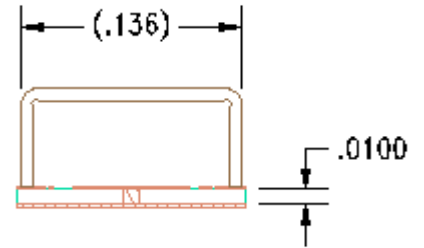
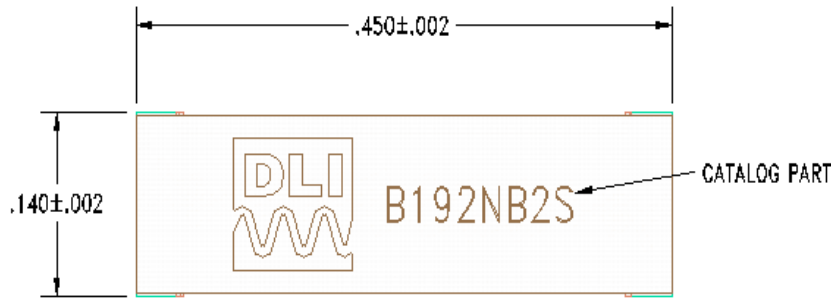

**DETAIL A**  
(2 PLACES)

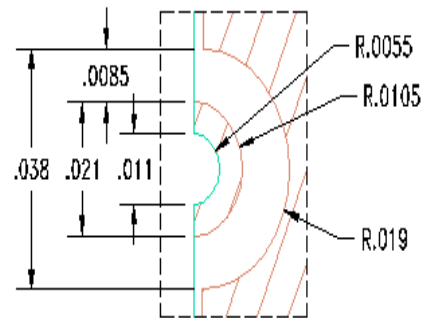

**Recommended PCB Layout**

