

CONFIGURATION TABLE					
PART NUMBER	C MIN [pF]	C MAX [pF]	TC [PPM/°C]	Q MIN. @ 1 MHz	MARKING COLOR
JZ030HV	1.5	3.0 +50% / -0%	0 ± 200	500	BLACK
JZ060HV	2.0	6.0 +50% / -0%	0 ± 300	500	BLUE
JZ100HV	2.0	10.0 +100% / -0%	0 ± 300	500	WHITE
JZ150HV	3.0	15.0 +100% / -0%	0 ± 500	500	PINK
JZ200HV	4.5	20.0 +100% / -0%	0 ± 500	500	RED
JZ300HV	5.5	30.0 +100% / -0%	-1500 ± 1000	200	ORANGE
JZ400HV	8.0	40.0 +100% / -0%	-1500 ± 1000	200	YELLOW
JZ500HV	8.0	50.0 +100% / -0%	-1500 ± 1000	200	GREEN

REVISION HISTORY					
ECO#	ZONE	REV	DESCRIPTION	DRAWN	APPROVED
			INITIAL RELEASE		AG
1392	ALL	A	JZ300HV, JZ400HV, JZ500HV ADDED; UPDATED TO CURRENT STANDARDS AND LATEST SPECIFICATIONS	EC 11/26/14	TD 12/04/14
1607	TAG	B	SPECS MATCHED TO CURRENT SALES BROCHURES (NOTE 5.1)	EC 05/12/17	EC 05/12/17
	ALL	C	REMOVED 8pF UNIT PART NUMBER FROM CHART	MI 03/29/22	

**NOTES:**

- INTERPRET DRAWING PER ANSI Y14.5M-1994.
- [ALTERNATE DIMENSIONS]** ARE IN MILLIMETERS.
- ELECTRICAL SPECIFICATIONS:
  - CAPACITANCE RANGE: *SEE CONFIGURATION TABLE.*
  - DC WORKING VOLTAGE AT MAX. RATED CAPACITANCE: 350 [VOLTS].
  - DC WITHSTANDING VOLTAGE AT MAX RATED CAPACITANCE: 770 [VOLTS].
  - Q FACTOR AT 1 [MHz] AND MAX RATED CAPACITANCE: *SEE CONFIGURATION TABLE.*
  - INSULATION RESISTANCE: 10<sup>4</sup> [MEGAOHMS] AT 25°C.
  - TEMPERATURE COEFFICIENT: *SEE CONFIGURATION TABLE.*
  - SELF RESONANT FREQUENCY MEASURED AT MAX RATED CAPACITANCE
- MECHANICAL SPECIFICATIONS:
  - TUNING TORQUE: 0.14 [in·oz] TO 1.00 [in·oz].
  - ALL PARTS FURNISHED ON 12 [mm] TAPE AND REEL; 1000 PIECES PER REEL.
- ENVIRONMENTAL:
  - OPERATING TEMPERATURE: -40°C TO +85°C.
  - RoHS COMPLAINT.

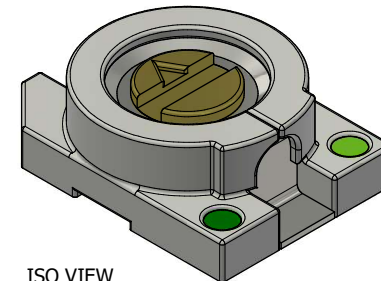

ISO VIEW  
SCALE 20 : 1

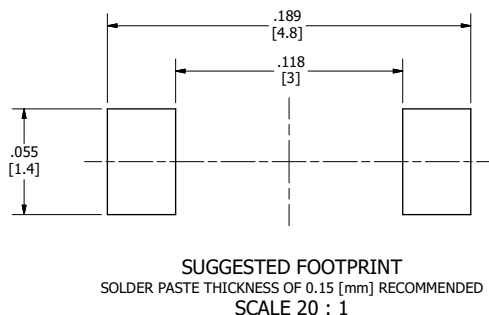
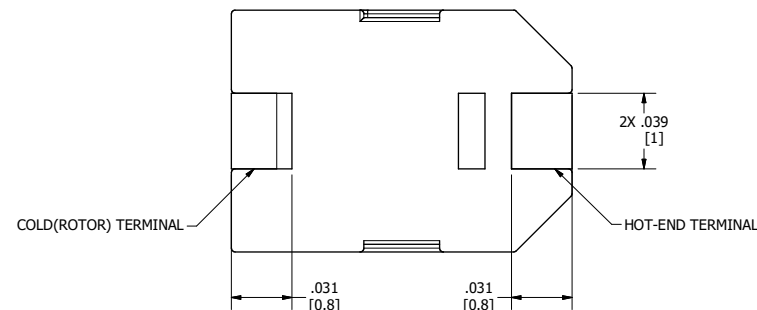
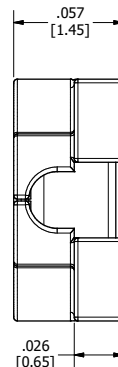
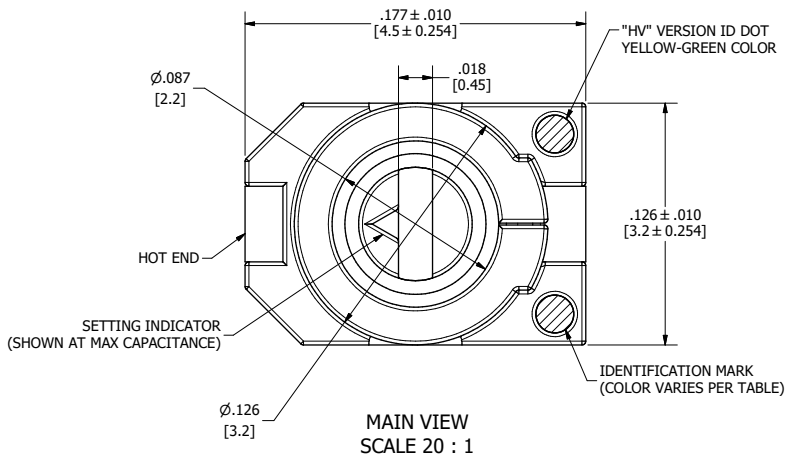

MATERIAL	N/A	DRAWN	E. CONTRERAS	11/26/2013
FINISH	N/A	CHECKED	T. BYRNE	12/10/2014
TOLERANCES	XX ± XXX ±.008 XXXX ± X°±1° X.X°±0.1°	QUALITY ASSURANCE	G. SATTERFIELD	12/12/2014
		MANUFACTURING	F. KHALIFEH	12/1/2014
		ENGINEERING	T. DOLAN	12/4/2014
		CUSTOMER PART NUMBER		
		INVENTOR 2013 GENERATED DWG		

**VOLTRONICS**  
 THE TRIMMER CAPACITOR COMPANY  
 2250 NORTHWOOD DRIVE  
 SALISBURY, MARYLAND 21801

**OUTLINE DRAWING FOR JZxxxHV SERIES**

SIZE	CAGE CODE	PART NUMBER	REV
C	55153	JZxxxHV	C
SCALE	PER VIEW	DWG NO.	SHEET 1 OF 2
		V-70513	

4

3

2

1

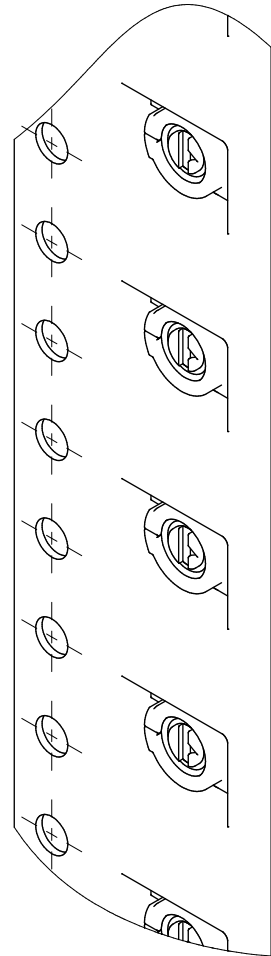
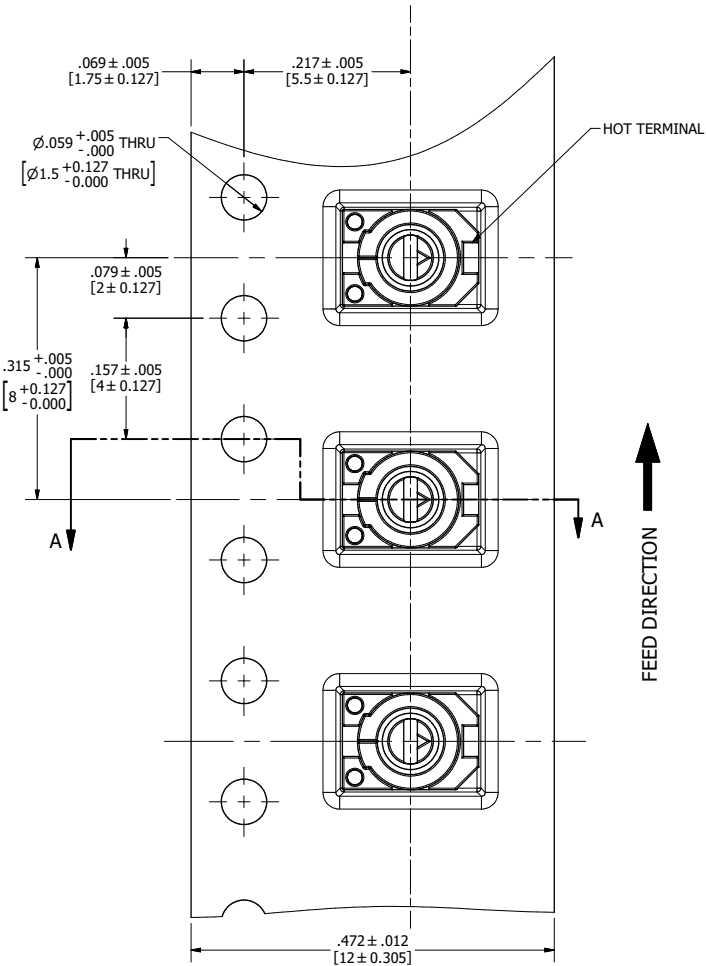
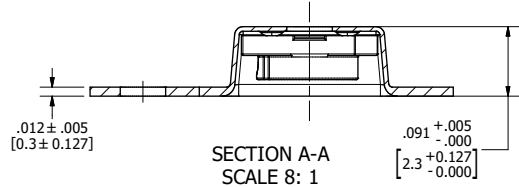

↑  
FEED DIRECTION

### HANDLING/STORAGE PRECAUTIONS:

- i.- DO NOT USE FLOW SOLDERING.
- ii.- DO NOT APPLY SOLDER OR FLUX TO ANY PARTS BUT TERMINAL
- iii.- WHEN USING SOLDERING IRON, THE SOLDERING IRON SHOULD NOT COME IN CONTACT WITH THE HOUSING OF THE CAPACITOR.
- iv.- PLEASE REFER TO SOLDER RECOMMENDATIONS CHART.
- v.- NO-CLEAN METHOD IS PREFERRED OVER SOLVENT WASHING. EXPERIMENT WITH SAMPLES BEFORE WASHING BY SOLVENTS.
- v.- DO NOT APPLY LOCKING SPRAY OR PAINT TO TRIMMER. ELECTRIC SPECIFICATIONS MAY BE AFFECTED ADVERSELY.
- vi.- PRODUCT CONTAINS LUBRICATION OIL. LUBRICATION LEAKS WILL NOT AFFECT PRODUCT SOLDERABILITY.
- vii.- USE OF CERAMIC SCREWDRIVERS IS RECOMMENDED FOR TUNING.
- viii.- DO NOT APPLY AXIAL LOAD DURING TUNING IN EXCESS OF 0.3[lbf]/1.5[N].
- ix.- KEEP PARTS OUT OF DIRECT SUNLIGHT EXPOSURE. STORE PARTS IN DUST-FREE ENVIRONMENT.

### SOLDERING RECOMMENDATIONS

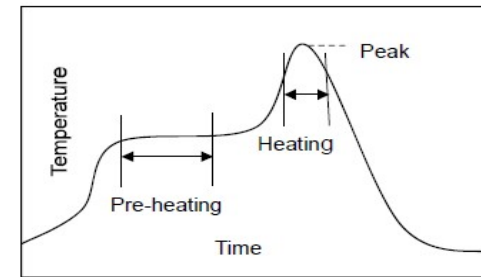

#### STANDARD LEAD-FREE SOLDERING PROFILE

STAGE	SAC305 SOLDER	EUTECTIC SOLDER
PRE-HEATING	TEMPERATURE: 150[°C] - 180[°C] TIME: 60 - 120 SECONDS	TEMPERATURE: 120[°C] - 150[°C] TIME: 60 - 120 SECONDS
HEATING	TEMPERATURE: 220[°C] MIN. TIME: 30 - 60 SECONDS	TEMPERATURE: 183[°C] MIN. TIME: 30 - 60 SECONDS
PEAK HEAT	TEMPERATURE: 265[°C] TIME: 3 SECONDS MAX	TEMPERATURE: 265[°C] TIME: 3 SECONDS MAX
REFLOW CYCLES	2 TIMES MAX	2 TIMES MAX
SOLDERING IRON		
SPEC	TEMPERATURE 400[°C] MAX TIME: 3 SECONDS MAX	

		VOLTRONICS		
		THE TRIMMER CAPACITOR COMPANY 2250 NORTHWOOD DRIVE SALISBURY, MARYLAND 21801		
DL1 • Novacap • Syfer • Voltronics	SIZE	CAGE CODE	PART NUMBER	REV
	C	55153	JZxxxHV	C
SCALE	PER VIEW	DWG NO.	V-70513	SHEET 2 OF 2