

## Lumped Lowpass Filter

### Features/Benefits

- 6 dB Gaussian
- Type N-F/Type N-M Connectors
- Made in U.S.A.



Parameter	Specification
Cutoff Frequency (Fc)	120 MHz
Passband	-3 dBa max from 0.5 MHz to 100 MHz
Rejection	-3 dBa min @ 130 MHz
Temperature, Operating	0°C to +50°C
Temperature, Storage	0°C to +50°C
Mechanical Dimensions	1.500 x 1.000 x 1.000 inches [38.10 x 25.40 x 25.40 mm] (L X W X H)

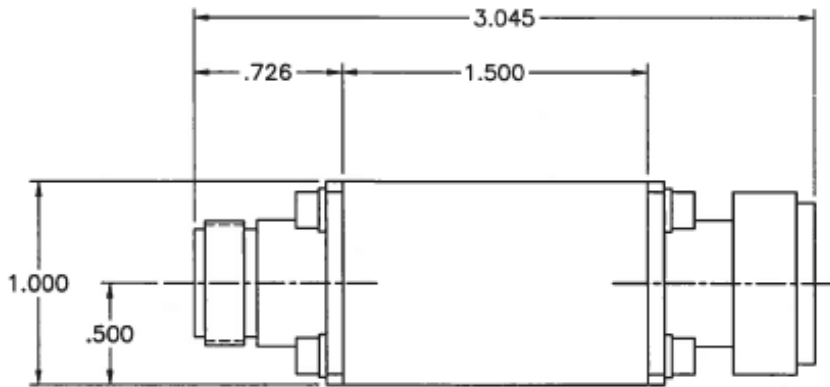

UNLESS OTHERWISE SPECIFIED  
DIMENSIONS ARE IN INCHES.  
TOLERANCES ARE:

INCHES	MILLIMETERS
.XX ± .02	[X.X] ± .5
.XXX ± .020	[X.XX] ± .51
.XXXX ± .0020	[X.XXX] ± .051

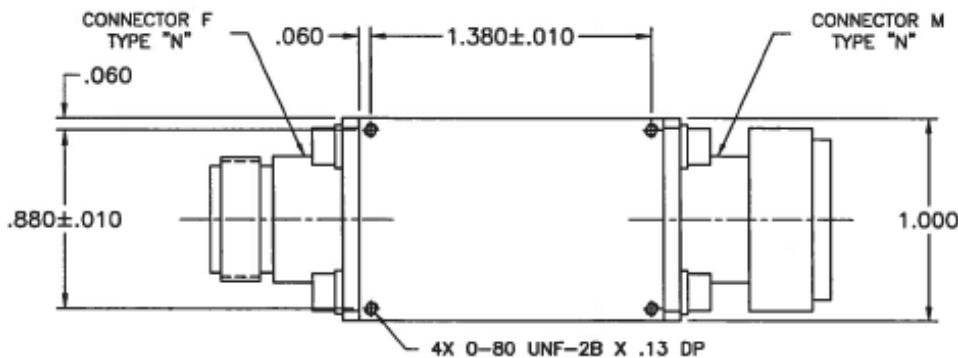

This document contains proprietary information and is to be used only for the purposes for which it has been supplied and is not to be duplicated or disclosed in whole or in part without written permission from a duly authorized representative of Knowles.

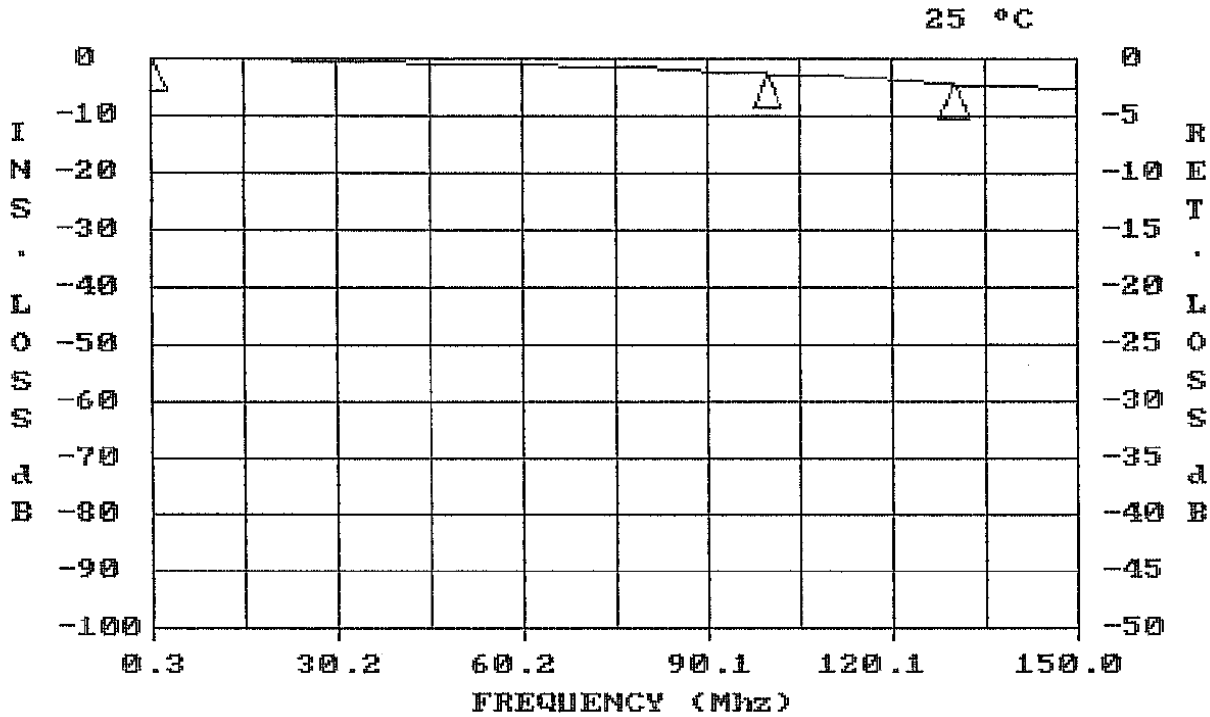

FREQUENCY (MHZ)	VALUE	SPEC	COMMENTS
130	-4.37 dbA	-3 dbA MIN	
.5 - 100	-2.71 dbA	-3 dbA MAX	

This document contains proprietary information and is to be used only for the purposes for which it has been supplied and is not to be duplicated or disclosed in whole or in part without written permission from a duly authorized representative of Knowles.

Phone: 1-315-655-8710 • Email: KPD-NA-sales@knowles.com • www.knowlescapacitors.com

Product and product information are subject to change without notice.