

Lumped Lowpass Filter

Features/Benefits

- SMA-F Connectors
- Made in U.S.A.

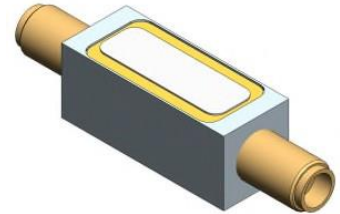

| Parameter | Specification |
|------------------------|---|
| Cutoff Frequency (Fc) | 9500 MHz |
| Passband | -2 dBa max from 130 MHz to 9500 MHz |
| Return Loss | -14 dB min from 50 MHz to 9500 MHz |
| Rejection | -20 dBc min @ 10000 MHz |
| Temperature, Operating | -40°C to +85°C |
| Temperature, Storage | -55°C to +105°C |
| Mechanical Dimensions | 1.000 x 0.400 x 0.400 inches [25.40 x 10.16 x 10.16 mm] (L X W X H) |

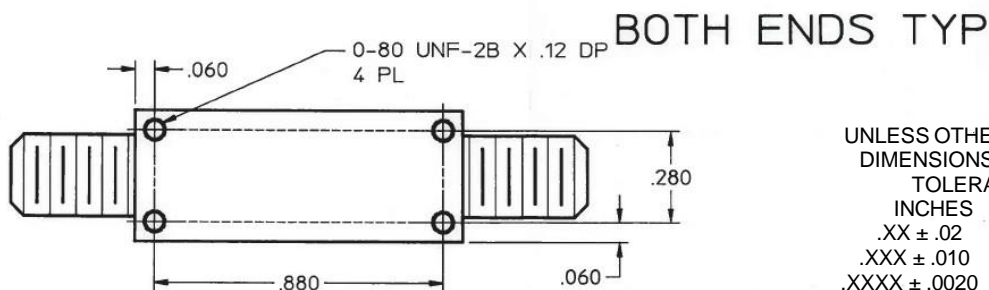
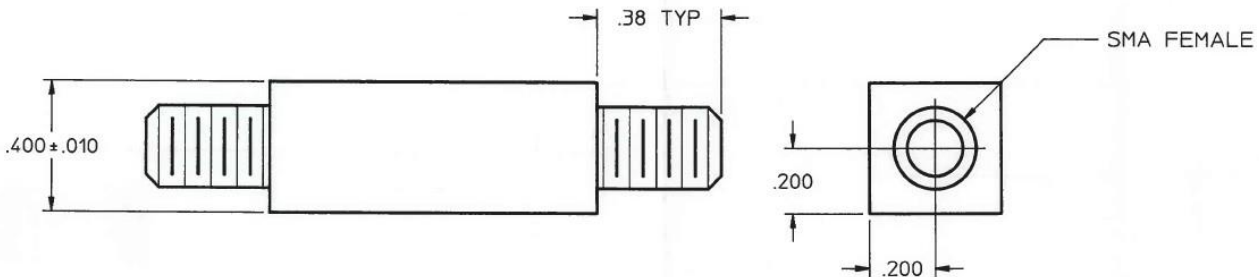
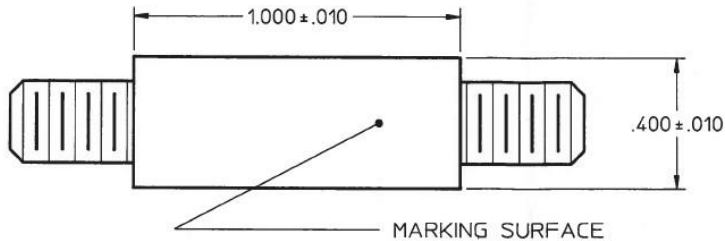

UNLESS OTHERWISE SPECIFIED
DIMENSIONS ARE IN INCHES.
TOLERANCES ARE:

| INCHES | MILLIMETERS |
|---------------|----------------|
| .XX ± .02 | [X.X] ± .5 |
| .XXX ± .010 | [X.XX] ± .25 |
| .XXXX ± .0020 | [X.XXX] ± .051 |

This document contains proprietary information and is to be used only for the purposes for which it has been supplied and is not to be duplicated or disclosed in whole or in part without written permission from a duly authorized representative of Knowles.

Phone: 1-315-655-8710 • Email: KPD-NA-sales@knowles.com • www.knowlescapacitors.com

Product and product information are subject to change without notice.

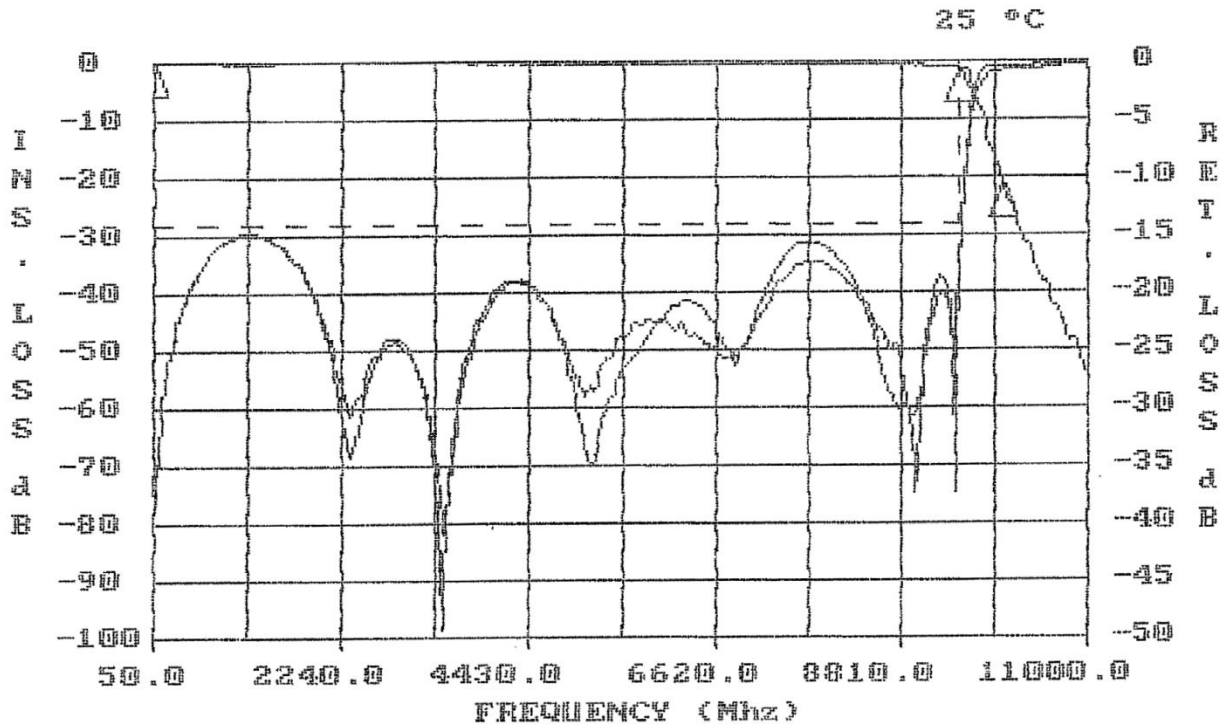

| FREQUENCY (MHZ) | VALUE | SPEC | COMMENTS |
|-----------------|-----------|-------------|--------------|
| 10000 | -20.9 dbC | -20 dbC MIN | |
| 130 - 9500 | -1.14 dbA | -2 dbA MAX | |
| FREQUENCY (MHZ) | VALUE | SPEC | COMMENTS |
| 50 - 9500 | -14.8 | -14 db MIN | (S11) - VSWR |
| 50 - 9500 | -14.8 | -14 db MIN | (S22) - VSWR |

This document contains proprietary information and is to be used only for the purposes for which it has been supplied and is not to be duplicated or disclosed in whole or in part without written permission from a duly authorized representative of Knowles.

Phone: 1-315-655-8710 • Email: KPD-NA-sales@knowles.com • www.knowlescapacitors.com

Product and product information are subject to change without notice.