

Lumped Lowpass Filter



Features/Benefits

- Surface Mount
- Vented
- Made in U.S.A.

Parameter	Specification
Cutoff Frequency (Fc)	1400 MHz
Passband	-0.25 dBa max from 1200 MHz to 1300 MHz
Return Loss	-15 dB min from 1200 MHz to 1300 MHz
Insertion Loss	-0.25 dBa max @ 1250 MHz
Rejection	-40 dBc min from 2300 MHz to 4000 MHz
Temperature, Operating	-20°C to +60°C
Temperature, Storage	-55°C to +125°C
Temperature, Soldering	+215°C MAX (use convective reflow)
Mechanical Dimensions	0.900 x 0.400 x 0.375 inches [22.86 x 10.16 x 9.53 mm] (L X W X H)

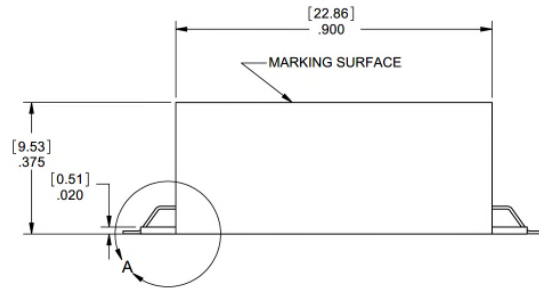

UNLESS OTHERWISE SPECIFIED
DIMENSIONS ARE IN INCHES.
TOLERANCES ARE:

INCHES	MILLIMETERS
.XX ± .02	[X.X] ± .5
.XXX ± .010	[X.XX] ± .25
.XXXX ± .0020	[X.XXX] ± .051

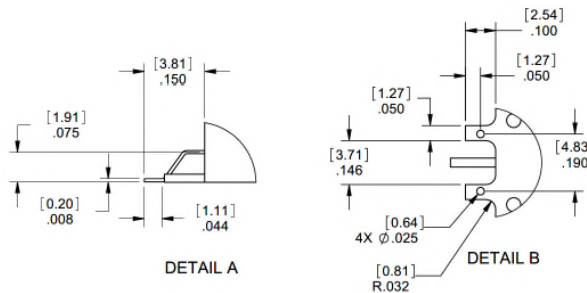
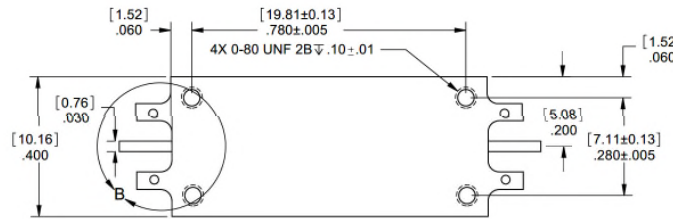

This document contains proprietary information and is to be used only for the purposes for which it has been supplied and is not to be duplicated or disclosed in whole or in part without written permission from a duly authorized representative of Knowles.

Phone: 1-315-655-8710 • Email: KPD-NA-sales@knowles.com • www.knowlesc capacitors.com

Product and product information are subject to change without notice.

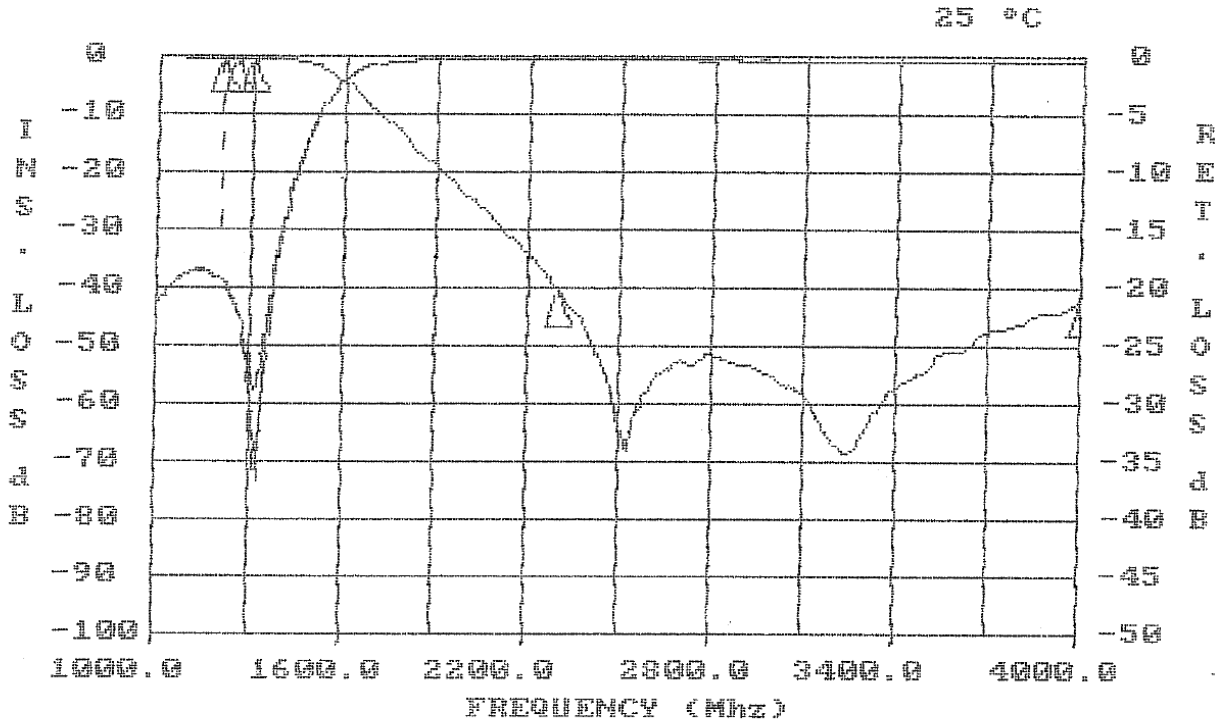

FREQUENCY (MHZ)	VALUE	SPEC	COMMENTS
1250	-.226 dbA	-.25 dbA MAX	
1200 - 1300	-.232 dbA	-.25 dbA MAX	
2300 - 4000	-40.7 dbC	-40 dbC MIN	

FREQUENCY (MHZ)	VALUE	SPEC	COMMENTS
1200 - 1300	-19.3	-15 db MIN	(S11) - VSWR
1200 - 1300	-19.2	-15 db MIN	(S22) - VSWR

This document contains proprietary information and is to be used only for the purposes for which it has been supplied and is not to be duplicated or disclosed in whole or in part without written permission from a duly authorized representative of Knowles.

Phone: 1-315-655-8710 • Email: KPD-NA-sales@knowles.com • www.knowlesc capacitors.com

Product and product information are subject to change without notice.